

Acoustic Membrane

Tools required

- Sharp insulation knife or cutting tool

Fixing and application

ROCKWOOL Acoustic Membrane should be laid directly onto the metal decking, across the line of the profiles. The metal decking must be clean and dry.

Align the membrane and extend the roll over the metal decking progressively.

Please note that it is not necessary to remove the protective plastic film.

All membrane joints should be overlapped by a minimum of 50mm as small openings can reduce the level of acoustic insulation achieved.

Where required, ROCKWOOL Acoustic Membrane is easily cut or shaped with a sharp knife.

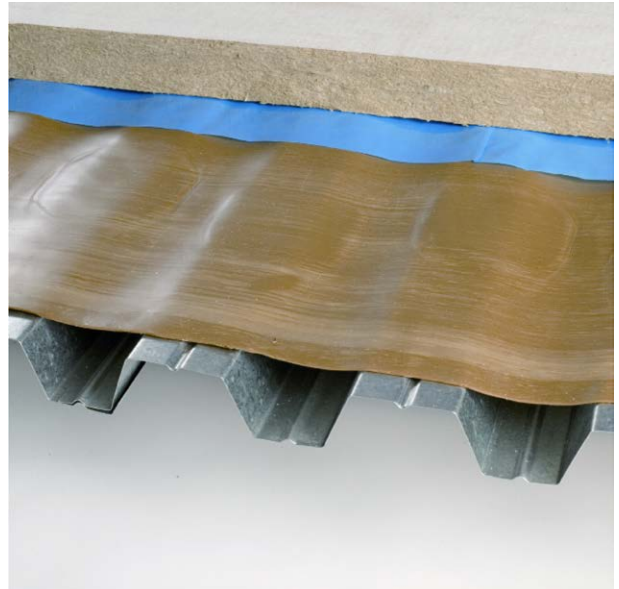

Coverage

For a 35mm deep profiled metal deck, each square metre of ROCKWOOL® Acoustic Membrane will cover approximately 0.95m² of surface area including overlaps. Coverage may vary for other profile types.

Health & safety

The mechanical effect of fibres in contact with skin may cause temporary itching.



Cover exposed skin
When working in unventilated area wear disposable face mask.



Clean area using vacuum equipment.



Waste should be disposed of according to local regulations.



Rinse in cold water before washing.



Ventilate working area if possible.



Wear goggles when working overhead.